

# ① Sections A (B-C) Very Old

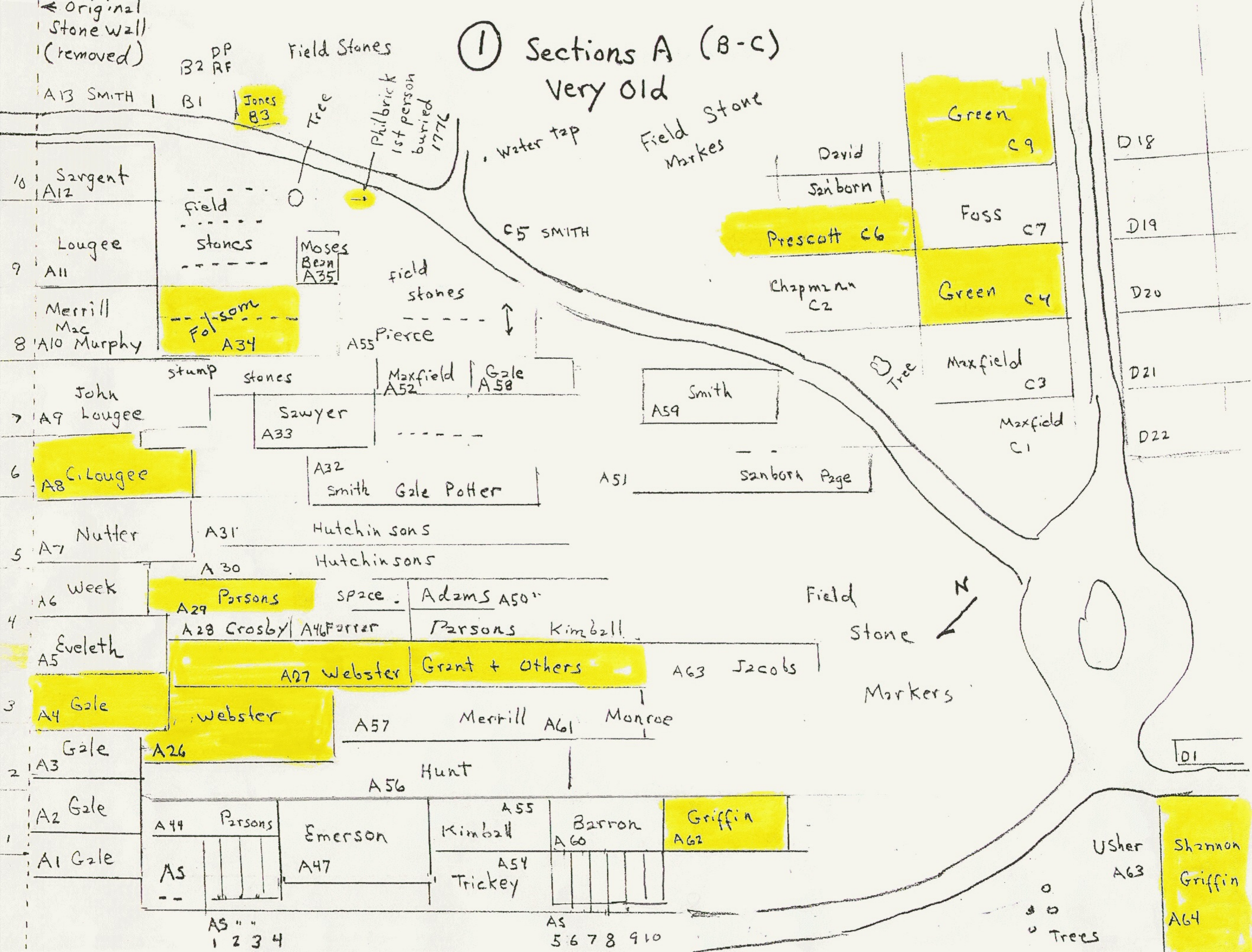

old wall removed

New Pond side II

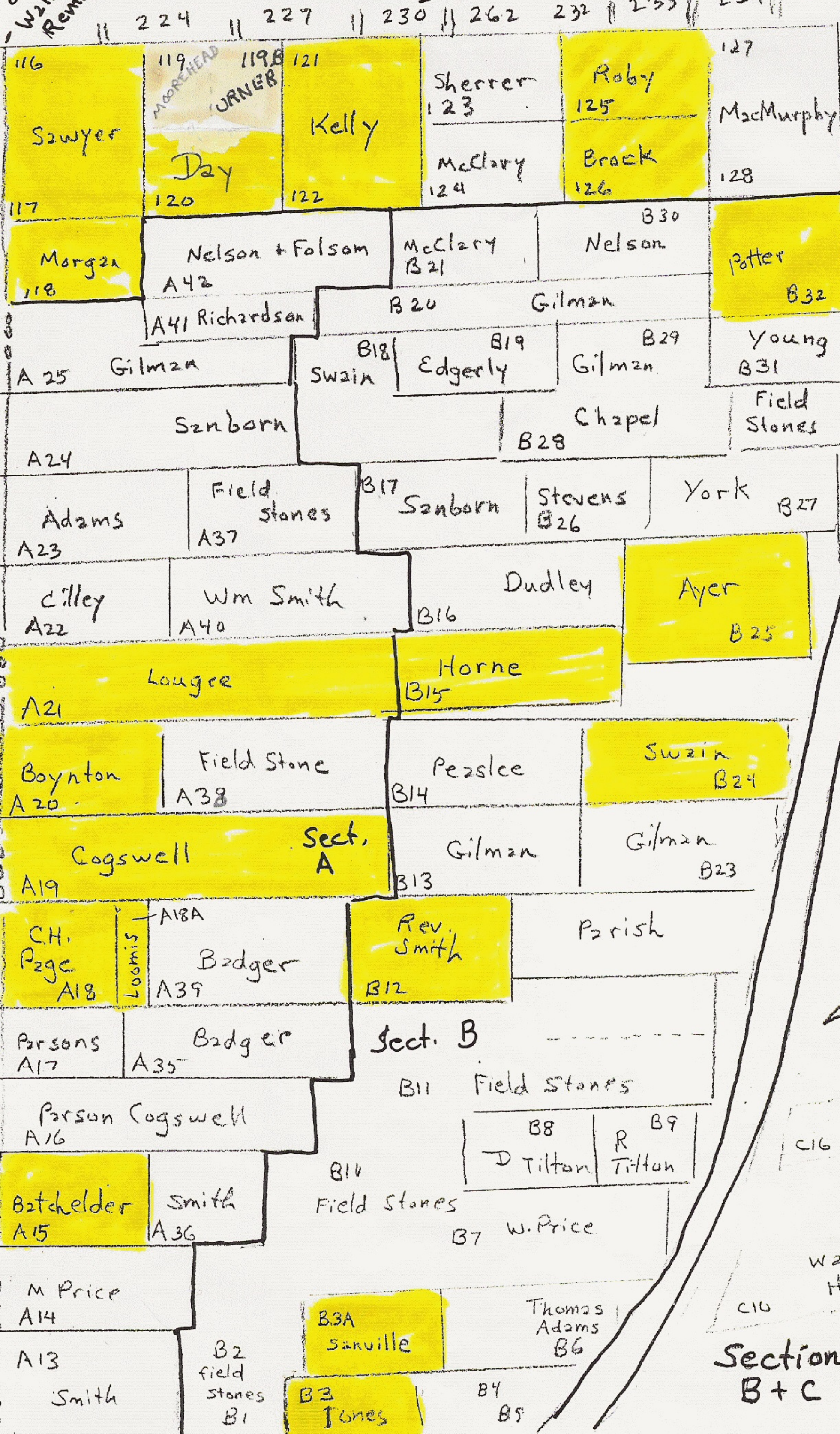

Field + Estate Sections  
Sect. F.  
Barr

Water DRAIN tap  
Sect. C.  
Field Stone

Hollis Clark C19  
Dr Otis French C18  
Hewitt C17 + Morgan  
Benj Bezn C21

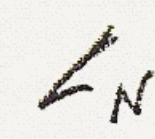

Sections A, B + C II (2)

Marsh  
80

57

34

11

Hughes

79A

Kitchen  
79

C. Martin  
56

Chas  
Nelson  
33

Price

10

30c

Barros

S. Blake  
78

Ezra Ham  
55

Nat  
Nelson  
32

Lewis  
Lougee  
9

29c

28c

27c

26c

25c

24c

Geo E  
Page  
77

Gale  
Eastman  
54

E.G.  
Edgerly  
31

Prescott  
8

23c

22c

Benj Page  
76

H G Page  
53

V. Parsons  
30

Gale

7

Barron

Westin

21c

20c

19c

18c

H Marsa  
75

S.J. Gale  
52

JK Dudley  
29

Judkins

6

17c

CA Paige  
74

J.C. Gale  
51

Moses  
Page  
28

Sam  
Folson

5

Hall

Hammond

Hammond

16c

15c

14c

SH Beck  
73

G  
Patter  
50

E Sanborn  
27

Hill

4

Aikens

12c

William  
Smith  
Nelson  
72

R.  
Griffin  
49

Gale  
Nelson  
26

Eveleth

3

11c

10c

9c

8c

7c

Cyrus  
Jones  
71

Thos  
Patter  
48

Moses  
Peaslee  
25

Peaslee

2

6c

5c

Dennett  
70

Nat  
Dudley  
47

Chas  
Dudley  
24

Dudley  
Young

1

3c

2c

1c

Belcher

3

Old I

1/4

101-A Studley 29ra  
 101-B Maganzini 19

Munse 72C  
 Munse 71E  
 Richer 70C

lette - 61c  
 Macmillan 60c  
 59c  
 Belanger 58c  
 Cook 57c  
 Mallory/Ball 56c  
 Poulin 55c  
 54c  
 53c  
 Comeau 52c  
 51c  
 Farr 50c  
 mart - 49c  
 47  
 48  
 47c  
 46c  
 Francis 45c  
 arnham 44c  
 43c  
 llins 42c  
 gelman 41c  
 z Croix 40c  
 o Smith 39c  
 o Smith 38c  
 ockbridge 37c  
 Hooper 37G

CREMAIN SECTION

201	204	207	210	213	216	63	221
Joe Page 101	Burres 104	Merrill-Balcom 107	Edgerly 110		Brown 113		116
Baker, Louise Hills-grove 102B	John Page 102A 105	Plummer 108	Edgerly 111		Nelson 114		117
Diamond 103	Hall 106	CARE C. Osbourne in 1989 Osgood 109	Beck 112		Jones 115		118
G.A. Gale 92	French 69	T. Gilman 46	Dudley Robinson 22		A25		
H.F. Gale 91	Oster 68	Benj Hall 45	Tilton Johnson 21A				
Geddes 40	C. Jones 67	C.G. Szuborn 44	A23				
AA Bennett 89	Webster 66	Tilton 43	Gilman Osborne 20		A22		
HA Page 88B	D.C. Page 65	H. Gilman 42	J Gilman 19		A21		
D.S. Page 87	Cotton 64	Stockbridge 41	Varney 18		A20		
Paige Morrison 86	R Bickford 63	CW Hall 40	Cogswell 17		A19		
W.C. Webster 85	Maxfield 62	Osgood 39	16		C.H. Page A18		
Flanders 84	Foss 61	French 38	15		Parson A17		
Whitehouse 83	Gault 60	J. Gilman 37	Jonz Brown 14		A16		
E Maxfield 82	Richardson 54	Math Folsom 36	W.N. Swzin 13		A15		
Osborne 81	J.C. Ham 58	E.T. Gilman 35	Orin Folsom 12		A14		
	Burgess		Z Peaslee				

4

N

Single  
Section - New  
(SMH Road side)

5

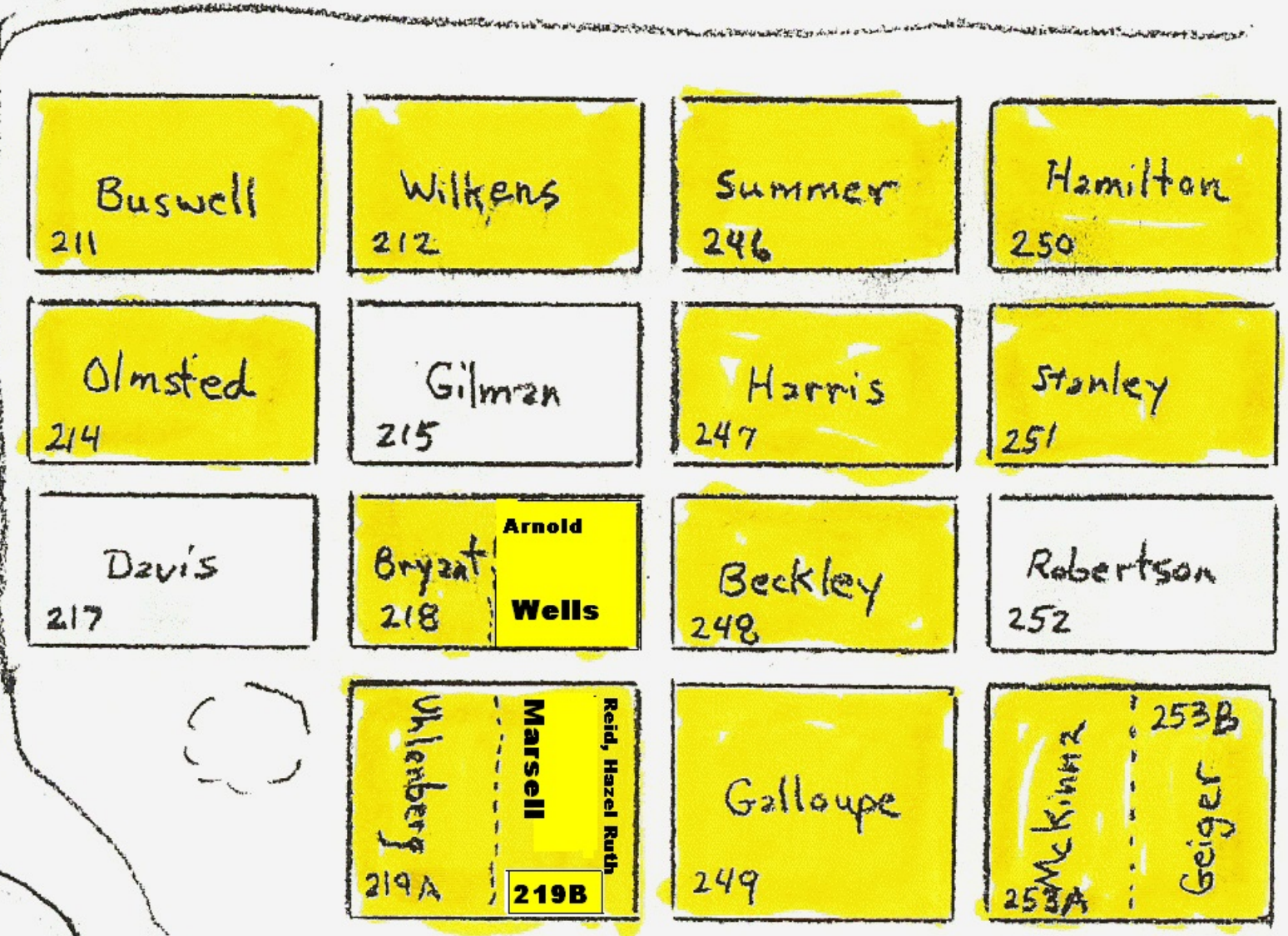
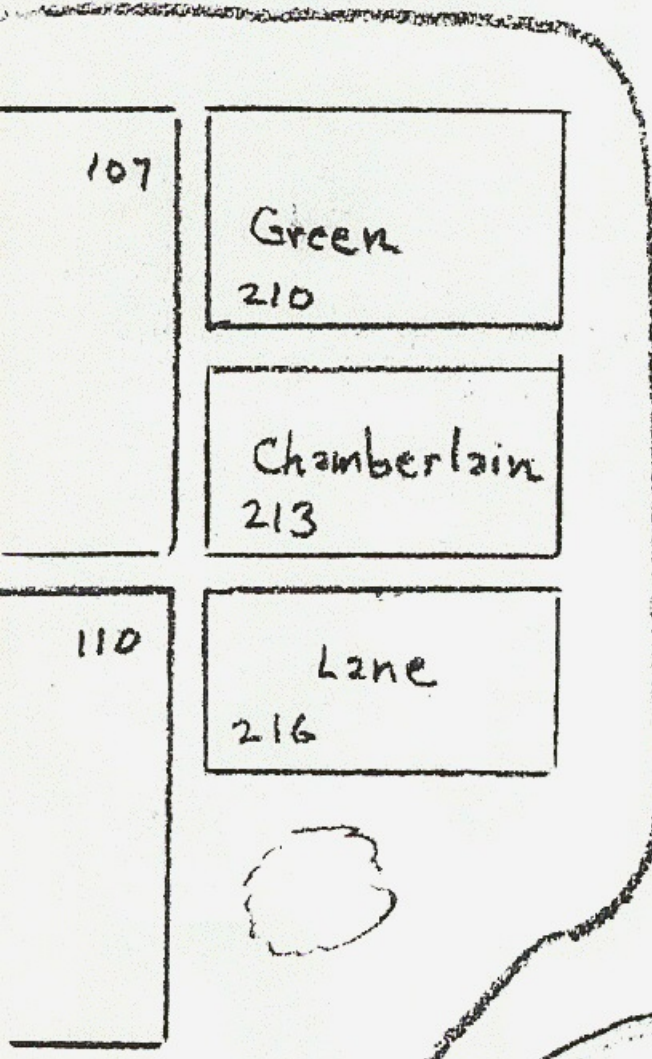
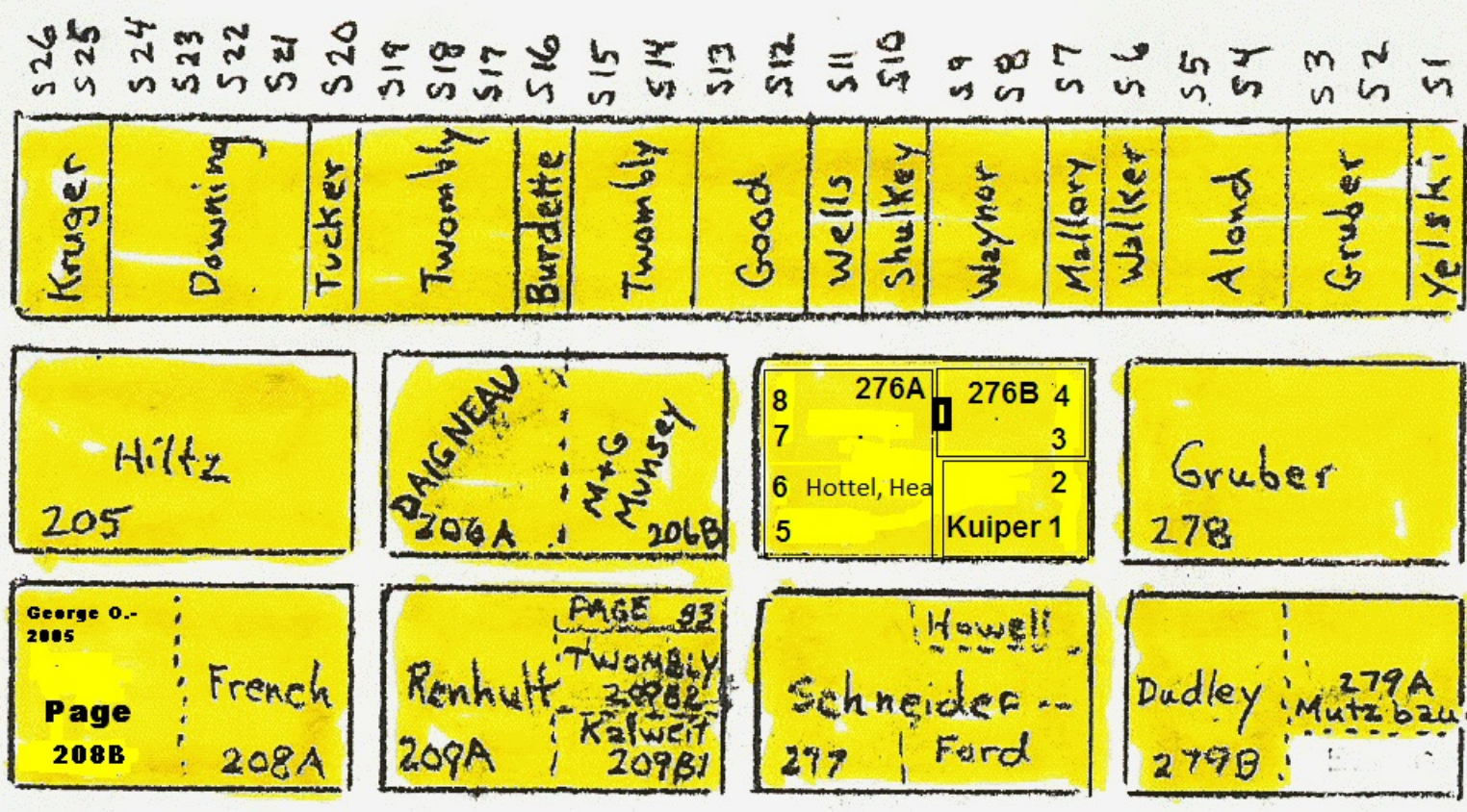
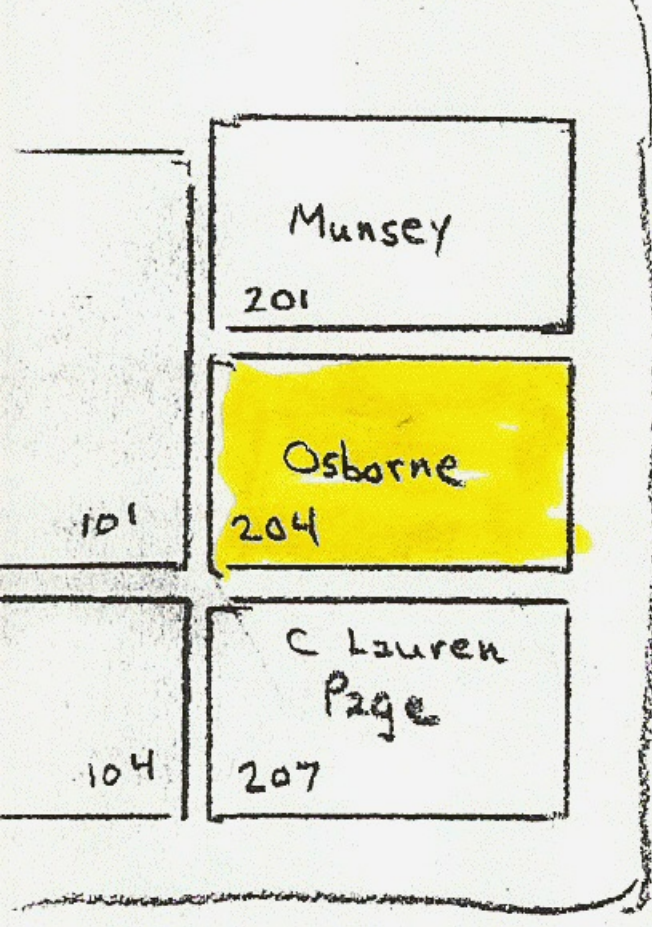

Section - New (Pond side) ↓

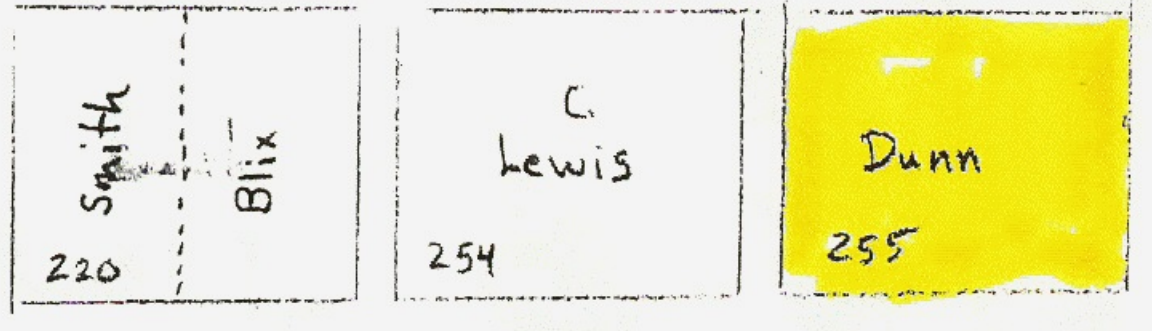

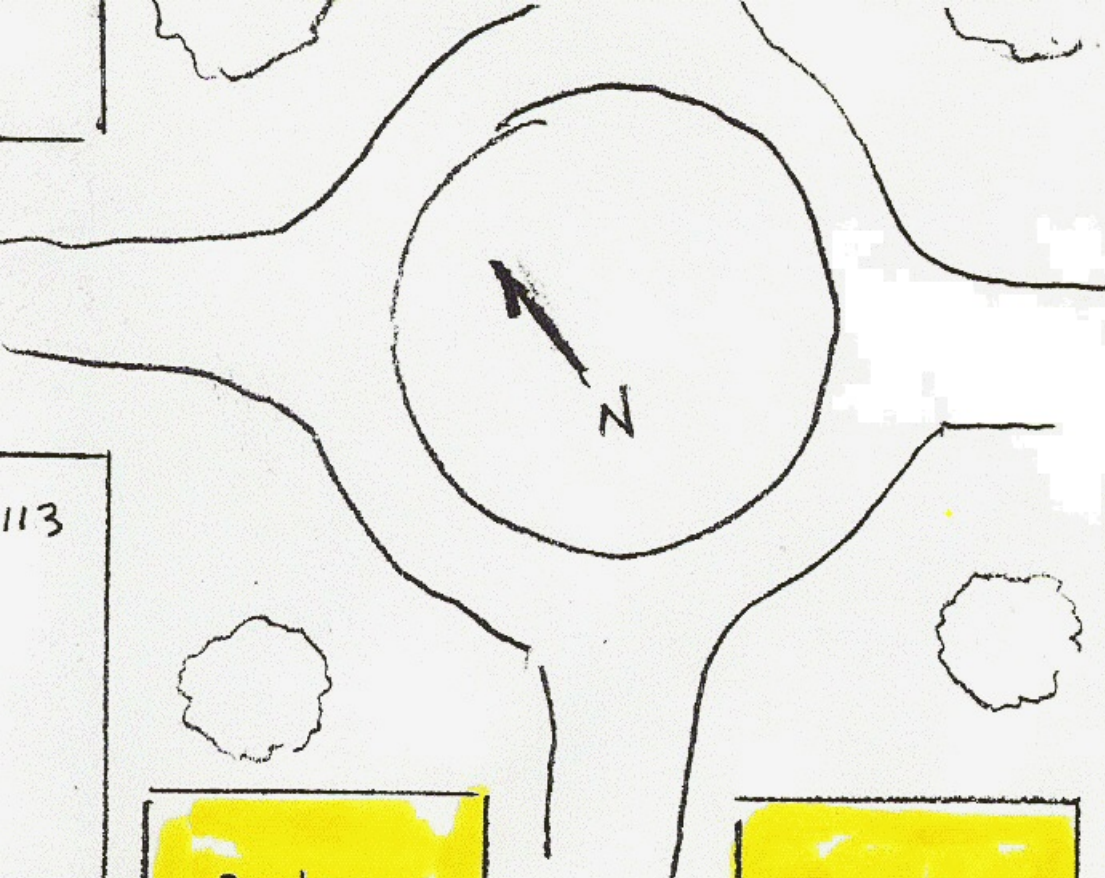

219 A   219 B	Galloupe 249	253 A   253 B
---------------	-----------------	---------------

6

Sect - New - Road side

113  
116  
119  
121  
123  
125  
127

		Smith 220	Blixt	Clyde - 1992 Mildred - 2005 <b>Lewis</b> 254	Dunn 255
Bordeau-Edgerly 221	Scoville Leeper 222		Dimock 223	Sidlauskas 256	Roberts 257
C Kelly 224	Nutter Bowdoin 225	226c Young	Davis	Collins 226A	Roberts 259B
McClary 227	Willard 228	Berry 226B	GRACE C. SMITH Cousins 229	John Kelley 260B	Geo Kelley 260A
Pennock 230	Bristol 236		Elmer 237A	Jail 237B	Green 237B
Davis 231	Besse 238		Hughes 239	Schumacher 268A	Stockbridge 268B
Osborne 232	<b>Golding</b> 240		Hawkins 241	Johnson 270B	Atwood 270A
Shaditsis 233	Berg 242		Davis 243	272B Farnsworth	272A Maher
Simoneau 234	Dawson 244		Metalious 245	Pennock 274	Kulash 273B
Forler 235					Gordon 273A
					Vorel 275

Section - New

Pond side

# Plan of Section D

Bean C21	Lewis Farrier C22
-------------	-------------------------

Connor C15	T Allen C14
Rhode Brown	Unknown
Unknown	John Adams C13
S Otis C11	

Field Stone Markers

Section C

Maxfield C1	Maxfield C3	Green C4	Foss C7	Green C9
----------------	----------------	-------------	------------	-------------

Section A

## Section F

D16		Parosky D31
D17 D Smithers		Wilson D32
Stackwell D17CA	Gilant D17CB	Gregg D33
stackwell D17B		Foster D35
D17A	D17	Fulweiler D34
D17B	Eisenhower D18	Porter-Gille D18A
D17C	stendor D19	Noran D19A
D17D	Morse Clayton D20	Games D20A
D17E	Deware D21	BlesL D21A
D17F	Green D22	Erwin D23
D17G		Urquhart D40

Warner + Downs D11	Brown D12
Young + Gilman D9	L. Young D10
Austine D8	Merrill D7
	Lavoie D6

Gilman Stones
Burgent D4
Unknown
Darrs D19B
Fleck

Ellsworth  
D1

C.W Gilman D2	Harvey D3 + Wymen	Gilman D4 Osgood	Gilman D5 Whitney
------------------	----------------------	---------------------	----------------------

Shannon Griffie A64	Fisher D1A	Towle- Stevens D2A	Whithed D3A	Skantz D4A	Glines D5A
---------------------------	---------------	--------------------------	----------------	---------------	---------------

Reserved for

Gilmans

Road

F + E Sect.  
Field + Estate Section

Sect C  
marked by  
Field Stones

field stone  
markers

Hollis Clark  
C19  
Dr Otis French  
C18  
Hewitt  
C17 + Morgan

Hutchinson  
Soldier +  
field stone  
markers  
Lewis  
Farrier  
C22  
Benji  
Behn  
C21

Connor  
C15  
Rhoda  
Brown  
C12  
T Allen  
C14  
C13

ard  
ckley  
C11  
S Otis

Barr  
Barr  
Roberts  
CB

- 1
- 2
- 3
- 4
- 5
- 6
- 7
- 8

D17A	D17B	D17C	D17D	D17E	D17F	D17G	D17H	D17I	D17J	D17K	D17L	D17M	D17N	D17O	D17P	D17Q	D17R	D17S	D17T	D17U	D17V	D17W	D17X	D17Y	D17Z
Douse	Stackwell	Stackwell	Smithers	Parosky	Clark	Clark	Clark	Clark	Clark	Clark	Clark	Clark	Clark	Clark	Clark	Clark	Clark	Clark	Clark	Clark	Clark	Clark	Clark	Clark	Clark
Ronning	Gallant	Gallant	Wilson	Small	Small	Small	Small	Small	Small	Small	Small	Small	Small	Small	Small	Small	Small	Small	Small	Small	Small	Small	Small	Small	Small
Morell	Gregg	Gregg	Wilson	Small	Small	Small	Small	Small	Small	Small	Small	Small	Small	Small	Small	Small	Small	Small	Small	Small	Small	Small	Small	Small	Small
Smith	Foster	Foster	Wilson	Small	Small	Small	Small	Small	Small	Small	Small	Small	Small	Small	Small	Small	Small	Small	Small	Small	Small	Small	Small	Small	Small
Clavasseur	Young + Gilman	Young + Gilman	Wilson	Small	Small	Small	Small	Small	Small	Small	Small	Small	Small	Small	Small	Small	Small	Small	Small	Small	Small	Small	Small	Small	Small
Aminault	Young + Gilman	Young + Gilman	Wilson	Small	Small	Small	Small	Small	Small	Small	Small	Small	Small	Small	Small	Small	Small	Small	Small	Small	Small	Small	Small	Small	Small
Fulweiler	Young + Gilman	Young + Gilman	Wilson	Small	Small	Small	Small	Small	Small	Small	Small	Small	Small	Small	Small	Small	Small	Small	Small	Small	Small	Small	Small	Small	Small
Sordelline	Young + Gilman	Young + Gilman	Wilson	Small	Small	Small	Small	Small	Small	Small	Small	Small	Small	Small	Small	Small	Small	Small	Small	Small	Small	Small	Small	Small	Small
Austin	Young + Gilman	Young + Gilman	Wilson	Small	Small	Small	Small	Small	Small	Small	Small	Small	Small	Small	Small	Small	Small	Small	Small	Small	Small	Small	Small	Small	Small
Lavoie	Young + Gilman	Young + Gilman	Wilson	Small	Small	Small	Small	Small	Small	Small	Small	Small	Small	Small	Small	Small	Small	Small	Small	Small	Small	Small	Small	Small	Small

Burbank  
D14

Gilman Stones

TREE

8



Barr ① Barr ② CB Roberts ③ ④ ⑤ ⑥ ⑦ ⑧



- Dambrosio H58
- Melanson H57
- Kelley H56
- Kelley H55
- Kelley H54
- Vermette H53
- Vermette H52
- Angevine H51
- H50
- Whitham H49