

322 David Smith	321 Hicks & Collier Sutland	331 E. & Eleanor Nelson	341 Eugene (North) Mason	352 George & Eliza Hill	362 Abel & Elizabeth Smith	372 James & Mary Lamb	382 Paul & Louisa Lamb
Herbert Mays	Geo Littlefield	Pardeby	W. P. Haynes	Wm Young	George Libbette		Perrett
Clarence H.	Harriet R. Bickel	Frank Blake	L. M. Han	Eva Smith	Alva Foss	W. S. Libbette	
John H. Williams	King & Glidden	Joseph M. Mason	R. M. Gray	George Ayers	Asa P. Page	Wm. S. Libman	Chas. Roberts
John & Page	E. J. Stone	William R. Page	Anna D. Eddy	Calvin Jenkins	Asa Wood	Frank Shannon	Emerson
Edison	E. J. Stone	E. S. Nelson	J. W. Ayers	Chas. F. Jenkins	L. A. Sackett	James Shannon	Henry Juggell
Oliver Larson	Sola M. Richardson	F. J. Elliott	A. W. Drakham	Molla Sackett	5 1 1 1	Asa P. Page	
Wm. G. Smith	Ann E. Breyer	Joseph Leavitt	J. W. Drakham	Thomas Collins	1 1 1 1	J. H. Sackett	Simon Combs
E. J. Stone	Ann G. M. Smith	J. C. Ayers	Asa C. Page	Jonathan Young	Journal Blake	S. W. Dow	Seldon Halliday
J. W. Stone	John H. Hall	William Pickering	J. M. Coffin	R. D. Trott	Calvin Furd	Chas. H. Shannon	Wm. E. Hill
Edison	J. G. Edgely	Wm. S. March	4 2 Tier	H. & E. (Hurd)	2 1 1 1	Ira Shannon	Chas. Nelson
Wm. Flanna Glidden	Albert R. Page	Paul Davis	Chas. & Lem Palmer	A. S. Lamprey	Chas. H. Manning	E. H. Sargent	J. M. Durgin
Henry Page	Henry Page	Henry Trott	1 1	6 2 Tier	7 2 Tier	8 2 Tier	
Evergreen							
26 W. S. Mason	2 Stephan L. Page	11 Wm. F. Eddy	11 W. Young	11 John K. Woodman	11 W. Manning	11 1 1 1 1 1 1 1	11 Eph. Shannon
9 F. Cannon	10 John L. E. Page	10 John E. Dingley	10 Quincy Page	10 Wm. Miller	10 Reuben Edgely	11 1 1 1 1 1 1 1	10 Jos. Libbette
20 Sarah Brickell	9 L. Conroy	9 Horace Edgely	9 A. H. Fitch	9 C. E. Furd	9 Jana Louge	10 Reuben Hurd	9 Wm. F. Page
9 Charles Emerson	9 Wm. Conroy	9 Wm. Edgely	9 David Trott	9 D. E. Drakham	9 St. M. Lougee	9 Hailan Page	9 Eben Cornell
8 L. H. Emerson	8 Call. Manning	8 John P. Eddy	8 North Page	8 J. H. Hurd	8 J. W. March	8 Asa Page	8 D. Libb
7 1/2 William H. Libb	7 H. Kimball	7 John Foss	7 Chas. F. Louge	7 J. H. Hurd	7 Amos March	7 1 1 1 1 1 1 1	7 John Knitter
7 John Libb	6 Daniel Conroy	6 Simon Foss	6 Job Jones	6 John Foss	6 J. S. Goodwin	6 William Thompson	6 T. L. Swan
6 J. Nelson	6 James Brighton	5 Ephel Hill	5 William Cuyll	5 Ephel Hill	5 David & John	6 Wm. H. Dow	5 1 1 1 E. S. Smith
5 S. C. Place	5 Ephel Hill	5 John Foss	5 John Foss	5 E. Trott	5 J. W. Young	4 T. Blake	4 Lamb D. Knitter
4 A. G. Louge	4 Eric Cook	4 John Foss	4 John Foss	4 John Foss	4 Sam. H. Hill	3 Mrs. Conall	3 E. Place
3 Wm. F. Furd	3 J. M. Pickering	3 Thos. S. Trott	3 John B. Hurd	3 John B. Hurd	3 Sam. H. Hill	3 Mrs. Conall	3 C. S. Hurd
3 Arthur F. Chase	3 D. Libb	3 L. P. Foy	3 Reuben Libb	3 Ephel Hill	3 A. F. Young	2 Thos. Merrill	2 J. Dingley
3 J. Marshall	2 Emmett Nelson	2 John Foss	2 Frank C. Coffin	2 David Goodwin	2 R. L. Page	2 Thos. Merrill	2 J. Dingley
3 Oscar Foss	2 John Foss	2 John Foss	2 Chas. F. Coffin	2 John Foss	2 D. L. Page	1 Thos. Merrill	1 J. Dingley
1 Franklin S. Place	1 Washington Libb	1 John Foss	1 John Foss	1 John Foss	1 John Foss	1 Thos. Merrill	1 J. Dingley

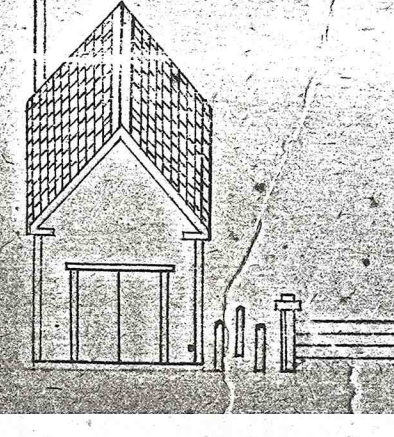

Single Lots, 11 x 22
 Double Lots, 22 x 23
 J. B. Foss, John P. Hurd, Proprietors.

Pine Cross Cemetery, Canton Iron Works Co.

October 1869.
 First interment, Francis, wife of P. Francis Williams, March 1869.

Created by J. B. Foss & Co. 1869

Avenues
 Main
 Margaret Drive